

Installation Note

Agilent Technologies 8560 and 8590 Series Spectrum Analyzers and E4900A Spectrum Monitoring System Rack Mount Kit

**Option 909 Rack Mount Kit, part number 5062-4840
(includes rack flange/handle kit, part number 5062-3985)**

**Option 908 Rack Mount Kit, part number 5062-4841
(includes rack flange/handle kit, part number 5062-3979)**



Part Number 5067-8588 Supersedes: November 1999

Printed in USA

April 2006

Notice.

The information contained in this document is subject to change without notice.

Agilent Technologies makes no warranty of any kind with regard to this material, including but not limited to, the implied warranties of merchantability and fitness for a particular purpose. Agilent Technologies shall not be liable for errors contained herein or for incidental or consequential damages in connection with the furnishing, performance, or use of this material.

© Copyright Agilent Technologies 1999, 2001

All Rights Reserved. Reproduction, adaptation, or translation without prior written permission is prohibited, except as allowed under the copyright laws.

1400 Fountaingrove Parkway, Santa Rosa, CA 95403-1799, USA

PRODUCTS AFFECTED: Agilent 8560 Series spectrum analyzer
Agilent 8590 Series spectrum analyzer
Agilent E4900A spectrum monitoring system

SERIAL NUMBERS: 0000A00000-9999A99999
0000U00000-9999U99999

OPTIONS: 908 and 909

TO BE PERFORMED BY: Agilent Service Center
 Personnel Qualified by Agilent
 Agilent Personnel On-site

ESTIMATED INSTALLATION TIME: 1.25 hours
Add 0.25 hours if installing the slide kit

Description

The following installation instructions apply to rack mount kits which mount the instrument in a rack with 482.6 mm (19 in.) spacing.

Tools Required

Description	Part Number
7-mm nut driver	8710-1217
4-mm hex (Allen) wrench	8710-1755
Large #2 Pozidrive screwdriver	8710-0900
Needlenose Pliers	8710-0595
TORX driver T-10	8710-1623
TORX driver T-15	8710-1622

Installation Kit Parts List

Table 1. Rack Mount Kit

Part Number	Quantity	Description
part number 5062-4840, Option 909 rack mount kit (includes part number 5062-3985, rack flange/handle Kit)		
0510-1148	7	Push on Retainer
0515-0049	5	Screw-M5 x 12MM-LG HX SKT HD
0515-0372	5	Screw-MM3.0 8 CWPNTX
0515-0458	9	Screw-MM3.5 8 CWPNTX
0515-1400	9	Screw-MM3.5 8 PCFLT
0515-2086	17	Screw-MM4.0 7 PCFLT
0515-0383	2	Screw-SMM4.0 16 CWPNTX
0535-0082	7	Nut with Lockwasher M4
2190-0587	5	Lockwasher M5
3050-0894	5	Flatwasher M5
5002-0637	1	Rear Support
5002-0639	1	Panel-Dress
5002-0638	1	Subpanel
5021-8407	1	Frame-Front
5021-5808	1	Frame-Rear
5021-5836	4	Corner Strut
5062-3985	1	Flange Handle Kit
8710-1755	1	Hex Key, 4MM
5067-8588	1	Installation note
part number 5062-4841, Option 908 rack mount kit (includes part number 5062-3979, rack flange kit)		
0510-1148	7	Push on Retainer
0515-0049	5	Screw-M5 x 12MM-LG HX SKT HD
0515-0372	5	Screw-MM3.0 8 CWPNTX
0515-0458	9	Screw-MM3.5 8 CWPNTX
0515-1400	9	Screw-MM3.5 8 PCFLT
0515-2086	17	Screw-MM4.0 7 PCFLT
0515-0383	2	Screw-SMM4.0 16 CWPNTX
0535-0082	7	Nut with Lockwasher M4
2190-0587	5	Lockwasher M5
3050-0894	5	Flatwasher M5
5002-0637	1	Rear Support
5002-0639	1	Panel-Dress
5002-0638	1	Subpanel
5021-8407	1	Frame-Front
5021-5808	1	Frame-Rear
5021-5836	4	Corner Strut
5062-3979	1	Flange Kit
8710-1755	1	Hex Key, 4MM
5067-8588	1	Installation note

Table 2. Rack Slide Kit

Part Number	Quantity	Description
part number 1494-0060, rack slide kit		
	2	Slides (Not sold separately)
0515-0949	4	Screw-SMM5.0 14 PNP
0515-1013	4	Screw-SMM4.0 12 FLP
0515-0909	4	Screw-SMM4.0 12 PNP
0535-0080	8	HexNut M4 W/LOCKWASHER
2680-0143	4	Screw 10-32 × 9/16 in. PNP

Safety Considerations

Warning **Before you disassemble the instrument, turn the power switch OFF and unplug the instrument. Failure to unplug the instrument can result in personal injury.**

Caution Electrostatic discharge (ESD) can damage or destroy electronic components. All work on electronic assemblies should be performed at a static-safe workstation. Refer to the documentation that pertains to your instrument for information about static-safe workstations and ordering static-safe accessories.

Installation Procedure

1. Remove the instrument's four front frame bumpers ①. See Figure 1.

Caution Use caution when placing the instrument dress panel face down on its finished surface. Use a soft cloth to protect the assembly from scratches or damage.

2. Place the kit's subpanel ② face down on a clean flat surface such as a desk top.
3. Place the instrument face down into the subpanel. Be sure to orient the instrument in relation to the subpanel mount holes ⑨ as illustrated in Figure 1.
4. Attach the subpanel to the top of the instrument's front frame using four M3 8 mm pan-head screws ③. The screws mount into the front bumper mounting holes.
5. Use a 4-mm hex key to unscrew the four screws ④ attaching the instrument cover assembly ⑤ to the instrument. Pull the cover assembly off to the rear of the instrument.
6. Remove the two screws ⑥ attaching the rear feet ⑦ to the cover assembly and remove the rear feet.

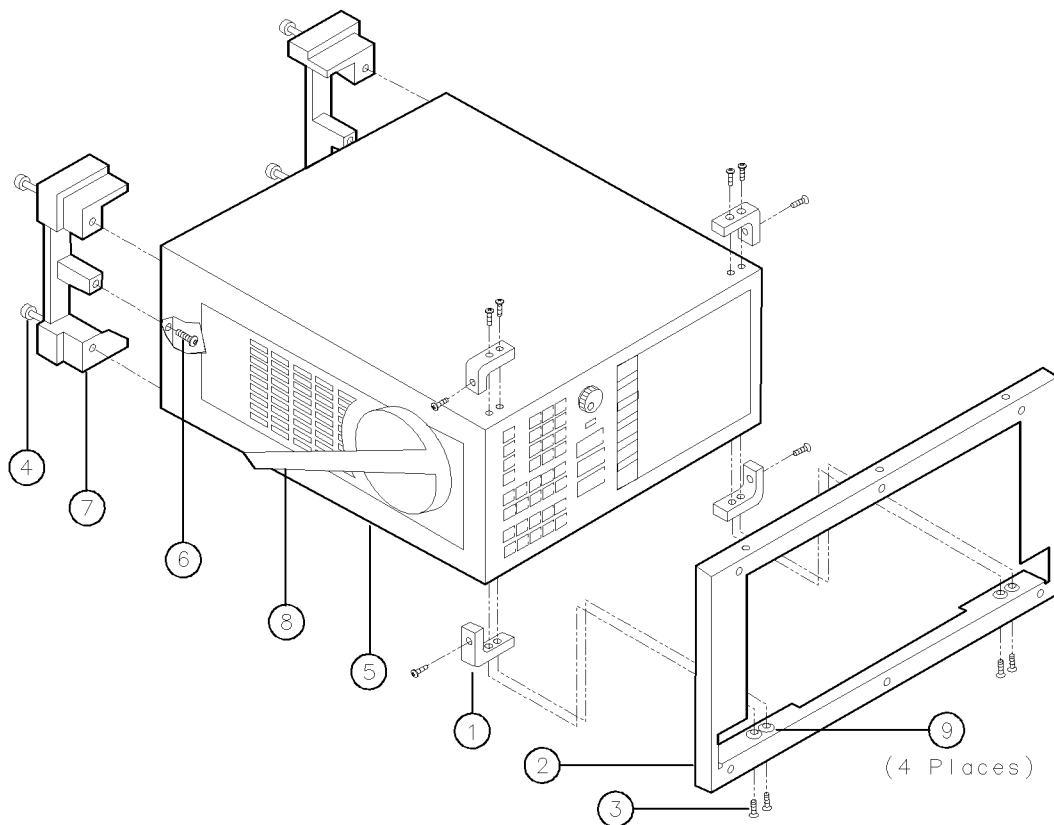

Figure 1. Installing the Rack Kit Subpanel

7. Remove the two screws attaching the bail handle assembly ⑧ to the cover assembly. The screws are located on the inside of the cover assembly. Pull each handle side straight out from the side of the cover assembly.

Caution When replacing the instrument cover, use caution to protect the instrument's cable assemblies from damage.

- Slide the cover assembly back on the instrument. If the cover assembly has a seam, locate the seam at the bottom side of the instrument. If the cover is seamless, locate the cover's air vent holes over the bottom side of the instrument.

Make sure that the instrument's cover assembly fits into the groove in the front frame all the way around the front frame.

- Replace the four screws and washers and attach the instrument cover to the rear frame.

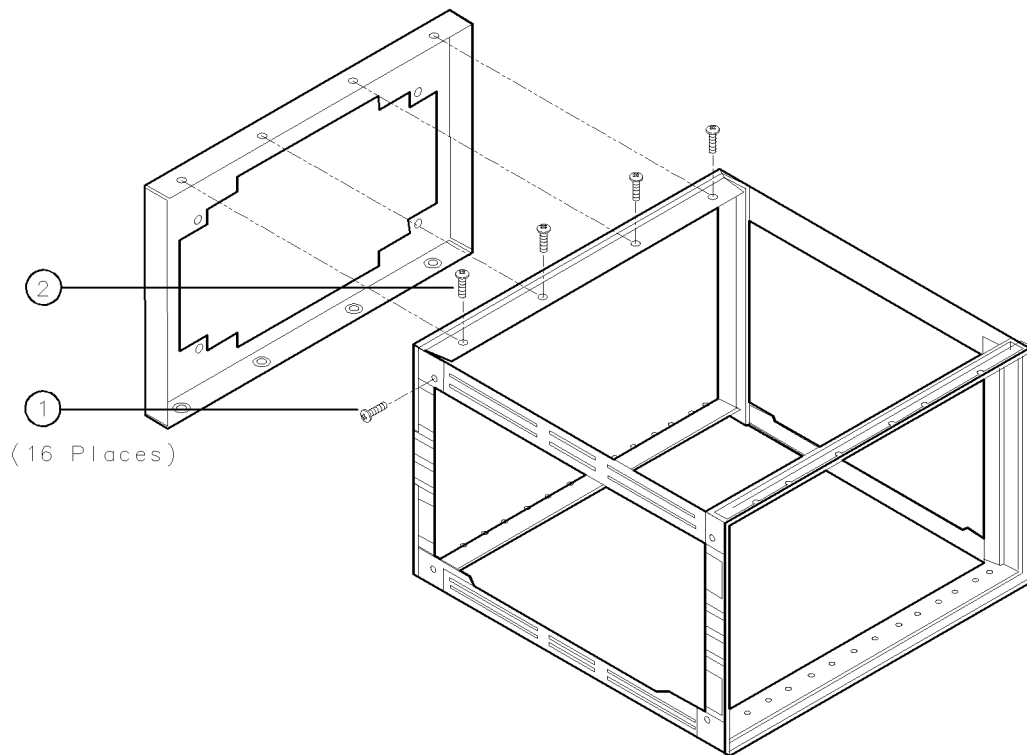

Figure 2. Assembling the Rack Frame

- Assemble the rack kit frame as illustrated in Figure 2, using 16 (four on each side) M4 6 mm flat-head screws (see ① in Figure 2) and eight M3.5 8 mm pan-head screws. (See ② in Figure 2.)

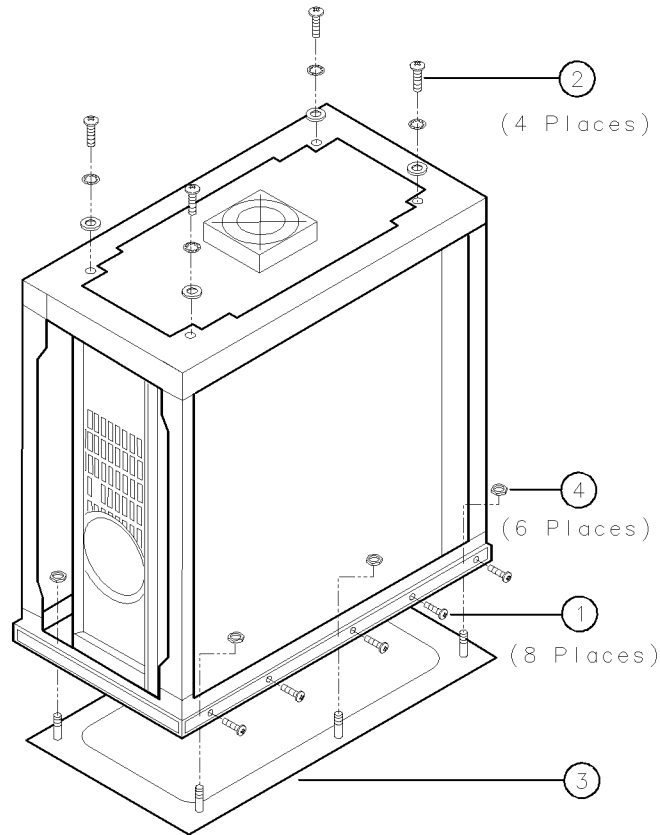

Figure 3. Attaching the Rack Frame to the Instrument

11. Place the rack frame over the instrument as illustrated in Figure 3. The rack front frame should have a deeper groove on the bottom side.
12. Attach the rack frame to the front support using eight M3.5 8 mm flat-head screws ①. See Figure 3.
13. Attach the rack frame to the rear of the instrument using four M5 12-mm socket head cap screws, lock washers, and flat washers. Use the hex key to torque to 50 inch-pounds. See ② in Figure 3.
14. Tip assembly on one side. Install the dress panel ③, and secure it with six nuts ④. Use a 7-mm driver. Torque to 6 inch-pounds maximum. *Do not* overtorque.

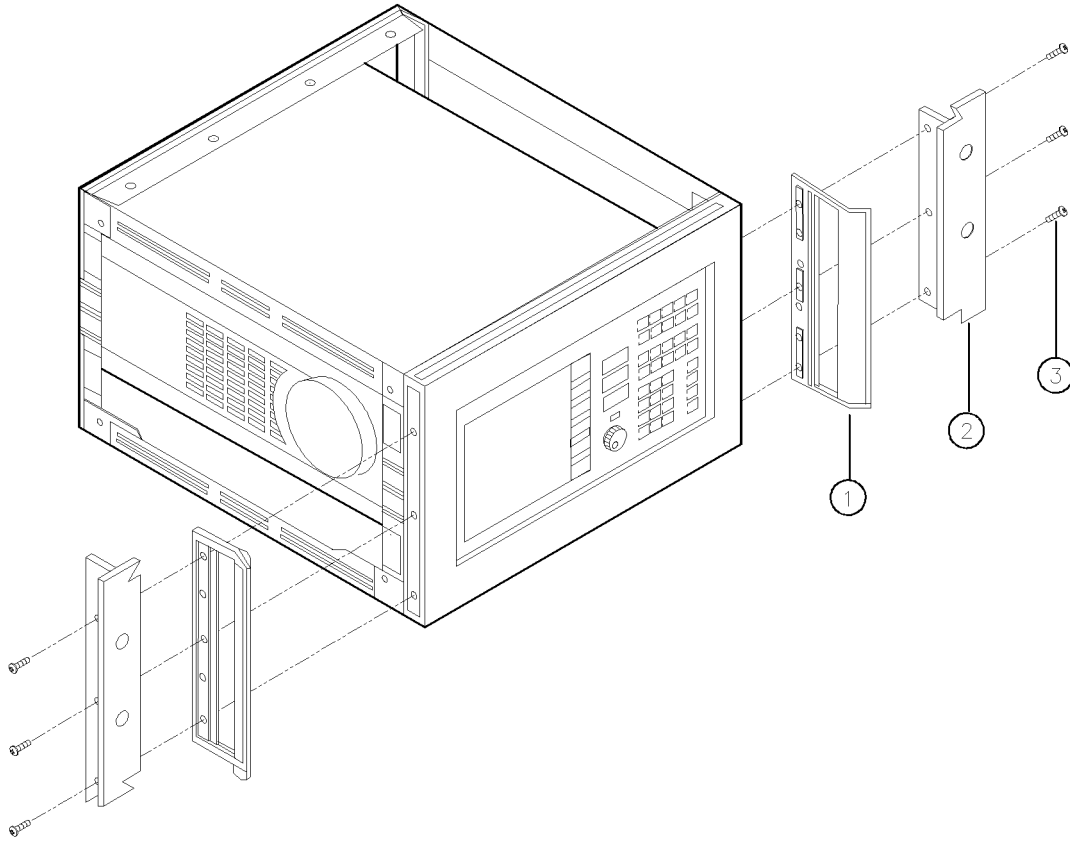

Figure 4. Installing Rack Flanges and Handles

15. Place the instrument in its operating position. See Figure 4. For part number 5062-4840 kits, mount the handles ① and rack flanges ② to the rack frame using six M4 16 mm pan-head screws ③. Part number 5062-4841 kits do not come with handles; the rack flanges mount directly to the rack frame using six M4 10 mm pan-head screws.
16. The instrument is now ready to mount into the systems rack.

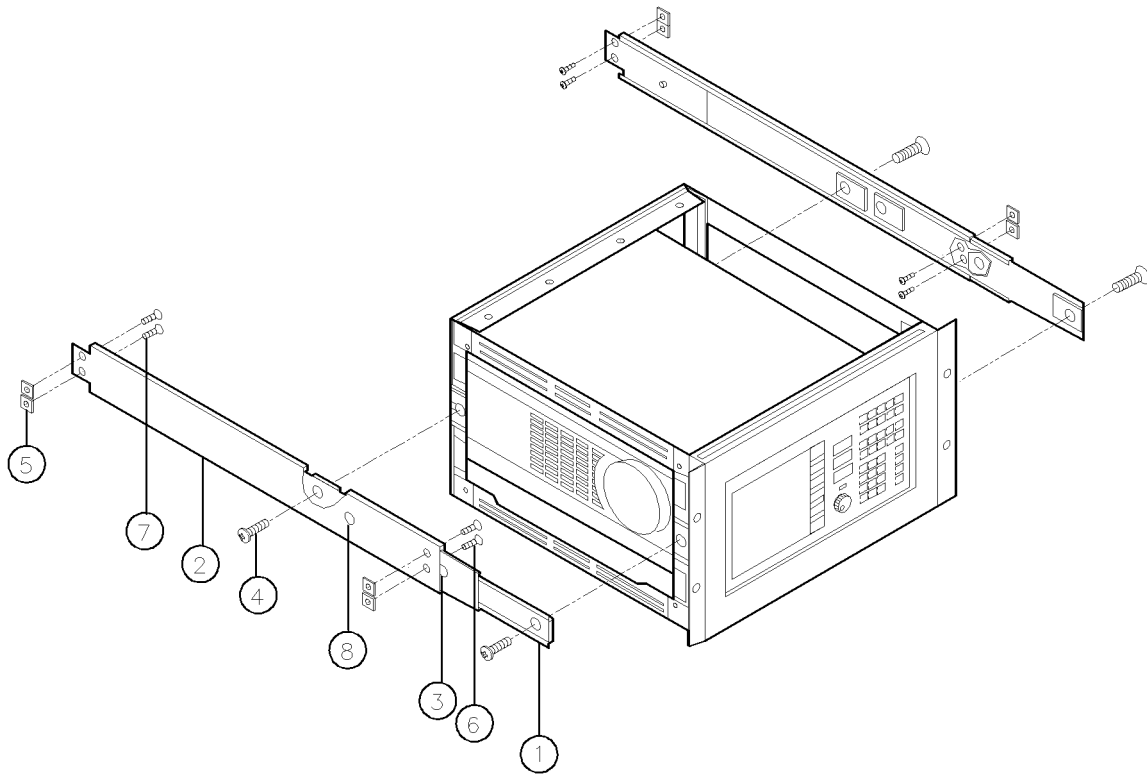

Figure 5. Installing the Rack Slide Kit

Installing the Rack Slide Kit

1. Install the part number 5062-4841 or 5062-4840 rack mount kit as described above.
2. Expand each rack slide to its full length.
3. Separate the inner slide member ① from the outer slide member ② by pressing release button ③ and pulling the inner slide member out. See Figure 5. Due to space considerations, Figure 5 does not show the rack slide extended to its full length.
4. Attach an inner slide member to each side of the rack mount frame using two M5 × 0.8 × 14 mm pan-head screws per side. See ④ in Figure 5.
5. Insert two unistrut nuts ⑤ in each of the four vertical columns of the systems rack.
6. Compress each outer-slide member to its shortest length, revealing the holes for screws ⑥. Release button ⑧ may have to be pressed.
7. Attach an outer slide member to each side of the systems rack using two M4 12 mm flat-head screws ⑥ in the front and two M4 12 mm pan-head screws ⑦ in the rear.
8. Place the instrument into the rack by sliding the inner slide members into the outer slide members. Use the release buttons, located on the slides, to enable complete compression of the slides.